

---

**ORDINARY MEETING**

**OF**

**ANNUAL PLAN/LONG-TERM PLAN COMMITTEE**

**MINUTES**

**Time:** 3:30 pm  
**Date:** Tuesday, 11 May 2021  
**Venue:** Ngake (16.09)  
Level 16, Tahiwī  
113 The Terrace  
Wellington

---

**PRESENT**

Deputy Mayor Free (Chair)  
Councillor Calvert  
Councillor Condie  
Councillor Day  
Councillor Fitzsimons  
Councillor Foon  
Councillor Matthews  
Councillor O'Neill  
Councillor Pannett  
Councillor Paul  
Councillor Rush  
Councillor Sparrow  
Councillor Woolf  
Councillor Young



---

**TABLE OF CONTENTS**  
**11 MAY 2021**

---

<b>Business</b>	<b>Page No.</b>
<b>1. Meeting Conduct</b>	<b>5</b>
<b>1.1 Karakia</b>	<b>5</b>
<b>1.2 Apologies</b>	<b>5</b>
<b>1.3 Conflict of Interest Declarations</b>	<b>5</b>
<b>1.4 Confirmation of Minutes</b>	<b>5</b>
<b>1.5 Items not on the Agenda</b>	<b>5</b>
<b>1.6 Public Participation</b>	<b>5</b>
<b>2. General Business</b>	<b>6</b>
<b>2.1 Long-term Plan Hearings</b>	<b>6</b>



---

## **1. Meeting Conduct**

---

### **1.1 Karakia**

The Chairperson declared the meeting open at 3:30 pm and invited members to stand and read the following karakia to open the meeting.

**Whakataka te hau ki te uru,  
Whakataka te hau ki te tonga.  
Kia mākinakina ki uta,  
Kia mātaratara ki tai.  
E hī ake ana te atākura.  
He tio, he huka, he hauhū.  
Tihei Mauri Ora!**

Cease oh winds of the west  
and of the south  
Let the bracing breezes flow,  
over the land and the sea.  
Let the red-tipped dawn come  
with a sharpened edge, a touch of frost,  
a promise of a glorious day

### **1.2 Apologies**

**Moved Deputy Mayor Free, seconded Councillor Foon, the following motion**

#### **Resolved**

That the Annual Plan/Long-Term Plan Committee:

1. Accept the apologies received from Mayor Foster for absence.

**Carried**

### **1.3 Conflict of Interest Declarations**

No conflicts of interest were declared.

### **1.4 Confirmation of Minutes**

**Moved Deputy Mayor Free, seconded Councillor Matthews, the following motion**

#### **Resolved**

That the Annual Plan/Long-Term Plan Committee:

1. Approve the minutes of the Annual Plan/Long-Term Plan Committee Meeting held on 6 May 2021, having been circulated, that they be taken as read and confirmed as an accurate record of that meeting.

**Carried**

### **1.5 Items not on the Agenda**

There were no items not on the agenda.

## 1.6 Public Participation

There was no public participation as this meeting was scheduled to only hear oral submitters.

## 2. General Business

### 2.1 Long-term Plan Hearings

**Moved Deputy Mayor Free, seconded Councillor Rush, the following motion**

#### **Resolved**

That the Annual Plan/Long-Term Plan Committee:

1. Receive the information.
2. Hear the oral submitters and thank them for their submissions.

**Carried**

**Secretarial note:** The following members of the public spoke to their submissions:

<b>Time</b>	<b>Name</b>	<b>Kind</b>
15:35	Great Harbour Way Trust - Ron Beernink	Organisation
15:45	NZ Memorial Museum Trust - Le Quesnoy - Sir Don McKinnon	Organisation
16:00	d sport - Catriona Mc Bean	Organisation
16:10	Wellington Heritage Week Trust - David Batchelor	Organisation
16:20	Steve West	Individual

### **Tabled items by oral submitters**

#### **Attachments**

- 1 Great Harbour Way Trust

---

The meeting concluded at 4:22 pm with the reading of the following karakia:

<b>Unuhia, unuhia, unuhia ki te uru tapu nui</b>	Draw on, draw on
<b>Kia wātea, kia māmā, te ngākau, te tinana, te wairua</b>	Draw on the supreme sacredness To clear, to free the heart, the body and the spirit of mankind
<b>I te ara takatū</b>	
<b>Koia rā e Rongo, whakairia ake ki runga</b>	Oh Rongo, above (symbol of peace)
<b>Kia wātea, kia wātea</b>	Let this all be done in unity
<b>Āe rā, kua wātea!</b>	

Authenticated: \_\_\_\_\_

Chair

---

**ORDINARY MEETING**

**OF**

**ANNUAL PLAN/LONG-TERM PLAN COMMITTEE**

**MINUTE ITEM ATTACHMENTS**

**Time:** 3:30 pm  
**Date:** Tuesday, 11 May 2021  
**Venue:** Ngake (16.09)  
Level 16, Tahiwī  
113 The Terrace  
Wellington

---

**Business**

**Page No.**

---

**Tabled items by oral submitters**

1. Great Harbour Way Trust

2





## Submission on the WCC Long Term Plan - May 2021

## Context

- **Reminder of the benefits of the Great Harbour Way**
  - Few places in the world that have this opportunity to create a continuous route that connects the ocean, harbour, our cities and our history.
  - Significant tourism drawcard, huge health and active transport benefits.
  - Submission to 3 Councils and other key stakeholders to deliver on these benefits.
- **Achievements to date**
  - Te Aranui o Pōneke / Great Harbour Way is now a well known concept.
  - WCC work on Cobham Drive and the Evans Bay to Oriental Bay routes.
  - Consent and funding for the Ngauranga-Petone seaside and Eastern Bays shared paths.
- **Our Submission**
  - The Long Term Plans for WCC, HCC, and GWRC needs to factor in further investment to realise the vision of the Great Harbour Way, and the investment in Te Ara Tupua, Cobham Drive and Oriental Bay routes.



## What we can achieve

- A significant tourism and recreation attraction; making Wellington and the wider region a destination to stay longer and spend more.
- Encouraging more people to walk, cycle and explore our harbour.
- Making it safe to do so for families with small children, elderly people and those with disabilities.
- Showing our ingenuity to create separated paths and closer connections to the harbour.
- Enabling a spine connecting other walking and cycling opportunities like the Remutaka trail.
- Having the route used for ultra-marathons, school trips, and other recreational events.
- Resulting in significant health benefits for our people and financial benefit for our city.
- Providing places where we bring people close to nature and in touch with our indigenous stories.





## Investments required as part of the Long Term Plan



### South coast / Seatoun

- Establish separated cycling and walking paths, or widen the shared footpath, or where this is not possible;
- Reduce traffic speed, giving priority to people on bikes.
- Remove pinch points.
- Include opportunities to protect the shoreline from the effect of climate change.
- Signage to show the start / end for the Great Harbour Way, and to provide information about our cultural history and heritage.

### Miramar Peninsula

- Urgently work with the Great Harbour Way Trust, other stakeholders and the Shelly Bay developers to come up with a plan to make the route around the Peninsula safe including during the development at Shelly Bay.
- Look at innovative options like boardwalks to separate walkers, or a one way lane between Shelly and Scorching Bay to free up a lane for cyclists and walkers.
- Create places where people can explore the seashore.



## Investments required as part of the Long Term Plan



### Evans-Oriental Bay, Wellington waterfront

- Continue with the great work started on the Oriental Bay separated cycle and walkways.
- Encourage commuter cyclists and scooterists away from the waterfront promenade; providing alternatives such as a bike lane along Jervis Quay.
- Signage promoting the whole of the Te Aranui o Pōneke route.

### CBD to Ngauranga Connection

- Fully back improvements to make Thorndon Quay safer for walkers and cyclists alike.
- Work with Centreport to ensure a top class walking and cycling connection to the new ferry terminal from both the CBD and Ngauranga.
- Widen the Hutt Road shared path and provide safer pedestrian & cyclist crossings at Ngauranga Interchange.

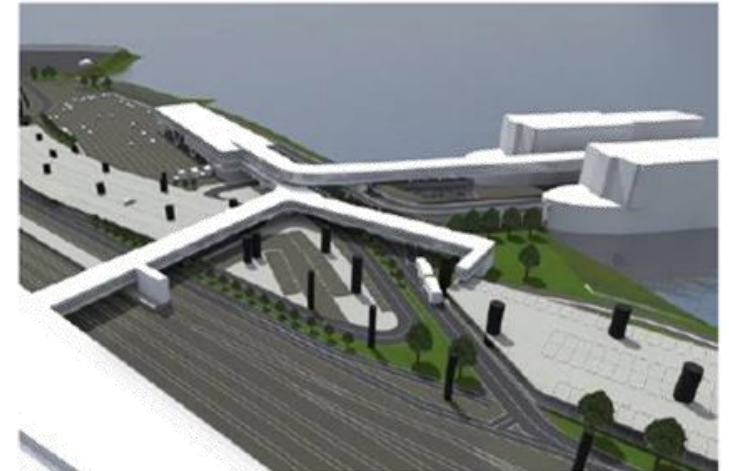



## In summary

- Include the investment in the Great Harbour Way / Te Aranui o Pōneke as part of the Long Term Plan.
- Work with the HCC, GWRC and other stakeholders to collectively realise the vision of the Great Harbour Way and its substantial benefits over the next few years.
- Reference the [detailed written submission](#) that we have provided to each of the Councils as well as the excellent [Boffa Miskell report](#) produced back in 2009 that highlights the issues and opportunities for the Great Harbour Way.
- Make sure that this Long Term Plan provides an excellent future for our whanau and tamariki, gifting them the amazing asset that the Te Aranui O Pōneke will be.

Ngā mihi nui  
The Great Harbour Way Trust

