

Zone 1 - Pedestrian Access (Typ) - Horizontal Illuminance  
Scale= 1: 50

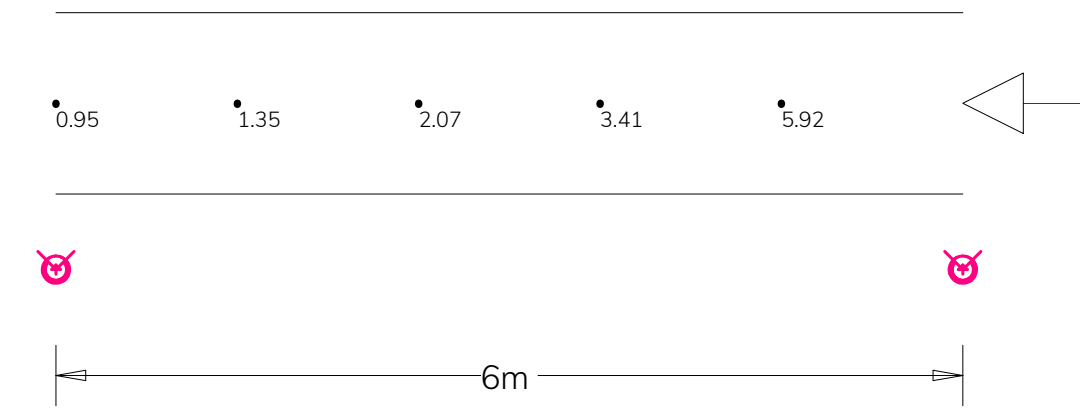

Zone 1 - Pedestrian Access (Typ) - Vertical Illuminance  
Scale= 1: 50



**KEY MAP ZONES**

- ZONE 1 - PEDESTRIAN FOOTPATH
- ZONE 2 - CONNECTING STEPS
- ZONE 3 - CARPARKING

**AS/NZS1158.2:2020 CALCULATION ZONES**

- HORIZONTAL ILLUMINANCE AREA
- VERTICAL ILLUMINANCE AREA

| Rev | Revision Detail         | Date     |
|-----|-------------------------|----------|
| 1   | Issued For LA Review    | 03.04.24 |
| 2   | Issued For Consent      | 08.04.24 |
| 3   | Revised for Proposed DP | 17.04.24 |
| 4   |                         |          |
| 5   |                         |          |
| 6   |                         |          |



| Name                | Date     |
|---------------------|----------|
| Surveyed: N/A       | N/A      |
| Designed: EWEN CAFE | 03.04.24 |
| Checked: EWEN CAFE  | 17.04.24 |

New World Khandallah  
Car Park Extension

**CALCULATION SUMMARY**

**TABLE 3.4**  
VALUE OF LIGHT TECHNICAL PARAMETERS FOR PATHWAYS AND CYCLIST PATHS

| Lighting subcategory | Average horizontal illuminance (E <sub>h</sub> ) lx | Point horizontal illuminance (E <sub>ph</sub> ) lx | Illuminance (horizontal) uniformity Cat. P (U <sub>1/2</sub> ) | Point vertical illuminance (E <sub>v</sub> ) lx |
|----------------------|---|--|--|---|
| PP1                  | 10  | 2  | 5  | 1   |
| PP2                  | 7   | 1  | 5  | 0.3   |
| PP3                  | 3   | 0.5  | 5  | 0.1   |
| PP4                  | 1.5   | 0.25   | 5  | 0.05  |
| PP5                  | 0.85  | 0.14   | 5  | 0.02  |

*Extract from AS/NZS1158.3.1:2020  
Refer original standard document for complete guidance to recommended LTP's*

**TABLE 3.7**  
VALUE OF LIGHT TECHNICAL PARAMETERS FOR OUTDOOR CARPARKS

| Lighting subcategory | Average horizontal illuminance (E <sub>h</sub> ) lx | Point horizontal illuminance (E <sub>ph</sub> ) lx | Illuminance (horizontal) uniformity Cat. P (U <sub>1/2</sub> ) | Point vertical illuminance (E <sub>v</sub> ) lx |
|----------------------|---|--|--|---|
| PC1                  | 14  | 3  | 8  | 3   |
| PC2                  | 7   | 1.5  | 8  | 1   |
| PC3                  | 3.5   | 0.7  | 8  | ---   |
| PCD                  | ---   | ≥14 and ≥(E <sub>h</sub> )                         | ---  | ---   |
| PCX                  | 21  | 5  | 8  | ---   |

*Extract from AS/NZS1158.3.1:2020  
Refer original standard document for complete guidance to recommended LTP's*

**CALCULATION RESULTS - AS/NZS1158.3.1:2020**

Project: 3-Spacing Calculations

| Label  | Description  | CalcType        | Units | Avg (E <sub>h</sub> ) | Max (E <sub>ph</sub> ) | Min (E <sub>ph</sub> ) | Max/Avg (Ue2) |
|--------|--|-----------------|-------|-----------------------|------------------------|------------------------|---------------|
| PP3_Eh | Zone 1 - Pedestrian Footpaths PP3 - Horizontal Illuminance | Illuminance     | Lux   | 25.07                 | 61.39                  | 6.94                   | 2.45          |
| PP3_Ev | Zone 1 - Pedestrian Footpaths PP3 - Vertical Illuminance   | Vertical Illum. | Lux   | 2.74                  | 5.92                   | 0.95                   | 2.16          |

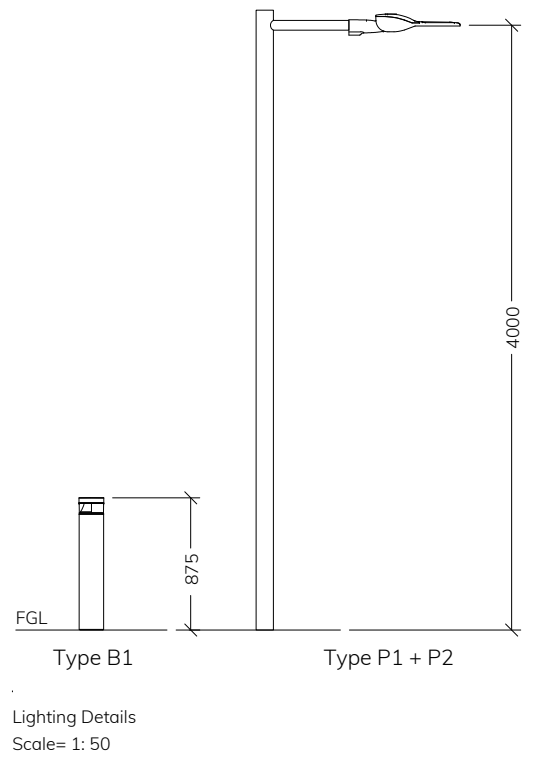

Lighting Details  
Scale= 1: 50

Sheet Title

AS/NZS1158.3.1:2020  
P-Category  
Spacing Calculations  
Lighting Details

| Project  | 24-025 | Sheet   | EL00 |
|----------|--------|---------|------|
| Scale A3 | NTS    | Version | 3    |



| Rev | Revision Detail         | Date     |
|-----|-------------------------|----------|
| 1   | Issued For LA Review    | 03.04.24 |
| 2   | Issued For Consent      | 08.04.24 |
| 3   | Revised for Proposed DP | 17.04.24 |
| 4   |                         |          |
| 5   |                         |          |
| 6   |                         |          |



|           | Name      | Date     |
|-----------|-----------|----------|
| Surveyed  | N/A       | N/A      |
| Designed  | EWEN CAPE | 03.04.24 |
| Checked   | EWEN CAPE | 17.04.24 |
| Job Title |           |          |

New World Khandallah  
Car Park Extension

Site Plan  
Lighting Arrangement

| Project      | 24-025 | Sheet   |
|--------------|--------|---------|
| Scale A3     | 1:400  | EL01    |
| AGI File Ref |        | Version |
|              |        | 3       |

| LUMINAIRE SCHEDULE          |     |       |  |       |                  |                 |                 |      |  |
|-----------------------------|-----|-------|--|-------|------------------|-----------------|-----------------|------|--|
| Project: 1-General Lighting |     |       |  |       |                  |                 |                 |      |  |
| Symbol                      | Qty | Label | Description  | LLF   | Luminaire Lumens | Luminaire Watts | Mounting Height | UWLR |  |
|                             | 13  | B1    | Disano FARO #510652-39 LED Bollard<br>230v 15w 3000K, 180deg Beam<br>c/w 875mm Round Post, Black Finish  | 0.900 | 623              | 15              | 0.875           | 0.15 |  |
|                             | 1   | H     | SUN Illuminated Handrail System<br>24v 15w/m 3000K - LED Integrated into handrail<br>Length TBC on site. | 0.100 | 247              | 9.24            | 0.9             | 0.00 |  |
|                             | 9   | P1    | Disano MINI GIOVI #331000-39 Area Light<br>230v 33w 700mA, 3000K<br>C/w 4m Column + 0.5m Outreach Arm    | 0.900 | 4881             | 33              | 4               | 0.00 |  |
|                             | 1   | P2    | Disano MINI GIOVI #331044-39 Area Light<br>230v 25w 530mA, 3000K<br>C/w 4m Column + 0.5m Outreach Arm    | 0.900 | 3943             | 25              | 4               | 0.00 |  |

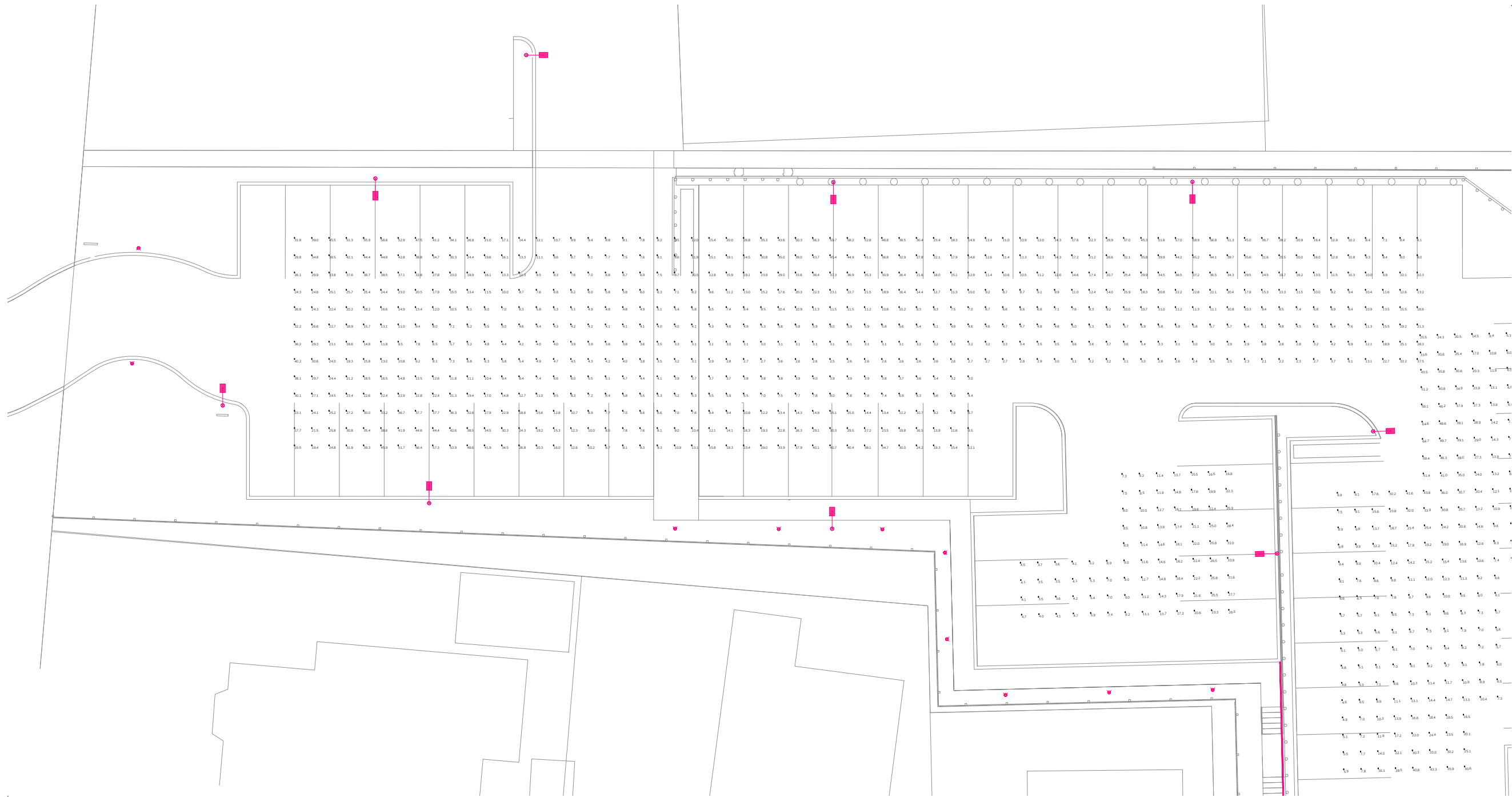

PLAN - Area 1  
Scale= 1: 250

| Rev | Revision Detail         | Date     |
|-----|-------------------------|----------|
| 1   | Issued For LA Review    | 03.04.24 |
| 2   | Issued For Consent      | 08.04.24 |
| 3   | Revised for Proposed DP | 17.04.24 |
| 4   |                         |          |
| 5   |                         |          |
| 6   |                         |          |



|           | Name      | Date     |
|-----------|-----------|----------|
| Surveyed  | N/A       | N/A      |
| Designed  | EWEN CAFE | 03.04.24 |
| Checked   | EWEN CAFE | 17.04.24 |
| Job Title |           |          |

New World Khandallah  
Car Park Extension

| CALCULATION RESULTS - AS/NZS1158.3.1-2020 SubCategory PC2 |   |             |       |          |           |           |               |
|---|---|-------------|-------|----------|-----------|-----------|---------------|
| Project: 1-General Lighting                               |   |             |       |          |           |           |               |
| Label   | Description                                   | CalcType    | Units | Avg (Eh) | Max (Eph) | Min (Eph) | Max/Avg (Ue2) |
| Eh01  | Carpark Area 1 - Horizontal Illuminance @ FGL | Illuminance | Lux   | 15.74    | 59.7      | 2.1       | 3.79          |
| Eh02  | Carpark Area 2 - Horizontal Illuminance @ FGL | Illuminance | Lux   | 13.78    | 33.9      | 3.5       | 2.46          |
| Eh03  | Carpark Area 3 - Horizontal Illuminance @ FGL | Illuminance | Lux   | 13.91    | 64.7      | 1.3       | 4.65          |

| Sheet Title   |         |       |
|---|---------|-------|
| Lighting Calculations<br>Point Illuminance<br>AS/NZS1158.3.1:2020<br>(Sheet 1 of 2) |         |       |
| Project   | 24-025  | Sheet |
| Scale A3  | 1:250   | ELO2  |
| AGI File Ref  | Version | 3     |

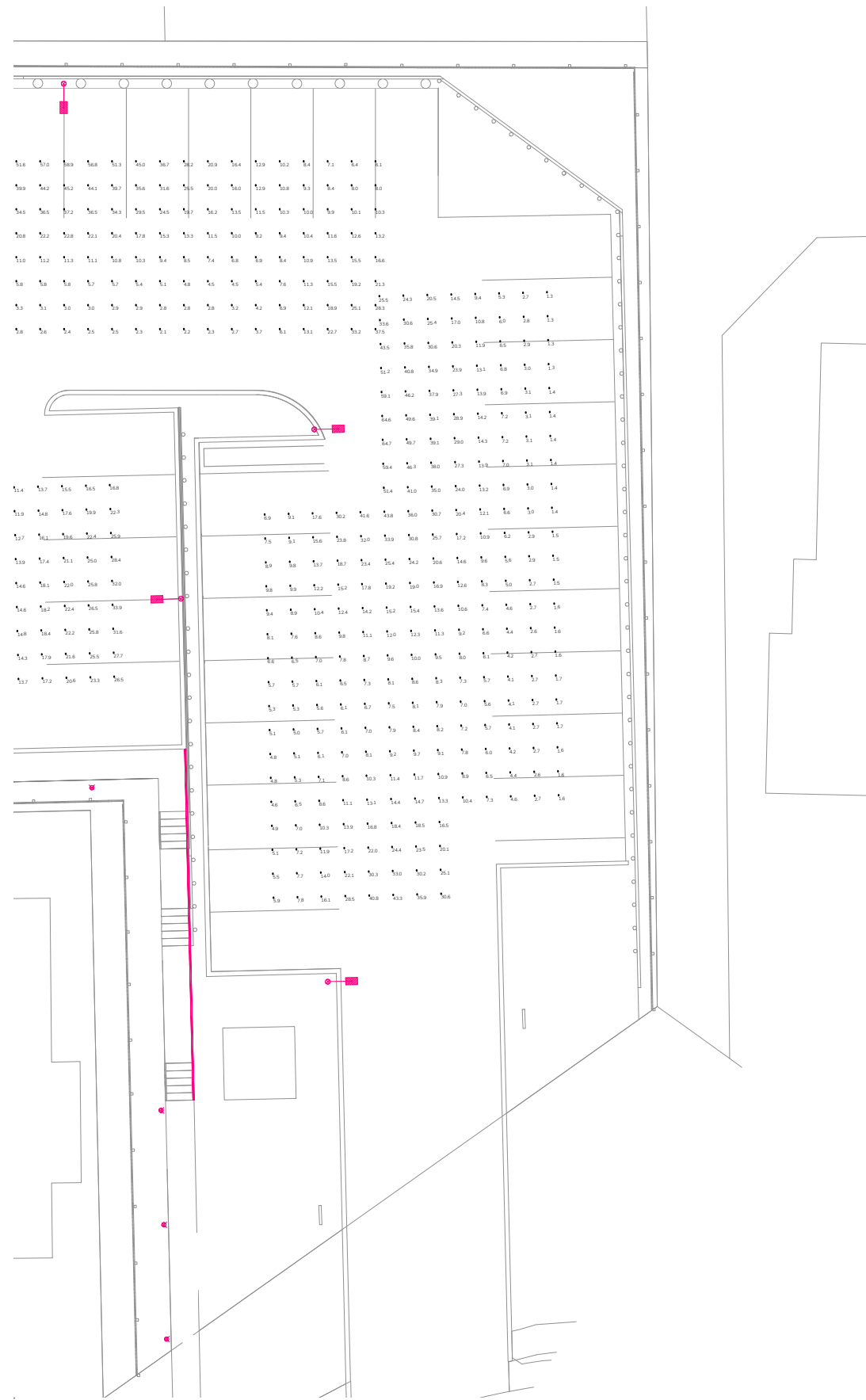

PLAN - Area 2  
Scale= 1: 250

| CALCULATION RESULTS - AS/NZS1158.3.1-2020 SubCategory PC2 |   |             |       |          |           |           |               |
|---|---|-------------|-------|----------|-----------|-----------|---------------|
| Project: 1-General Lighting                               |   |             |       |          |           |           |               |
| Label   | Description                                   | CalcType    | Units | Avg (Eh) | Max (Eph) | Min (Eph) | Max/Avg (Ue2) |
| Eh01  | Carpark Area 1 - Horizontal Illuminance @ FGL | Illuminance | Lux   | 15.74    | 59.7      | 2.1       | 3.79          |
| Eh02  | Carpark Area 2 - Horizontal Illuminance @ FGL | Illuminance | Lux   | 13.78    | 33.9      | 3.5       | 2.46          |
| Eh03  | Carpark Area 3 - Horizontal Illuminance @ FGL | Illuminance | Lux   | 13.91    | 64.7      | 1.3       | 4.65          |

| Rev | Revision Detail         | Date     |
|-----|-------------------------|----------|
| 1   | Issued For LA Review    | 03.04.24 |
| 2   | Issued For Consent      | 08.04.24 |
| 3   | Revised for Proposed DP | 17.04.24 |
| 4   |                         |          |
| 5   |                         |          |
| 6   |                         |          |



|           | Name      | Date     |
|-----------|-----------|----------|
| Surveyed  | N/A       | N/A      |
| Designed  | EWEN CAFE | 03.04.24 |
| Checked   | EWEN CAFE | 17.04.24 |
| Job Title |           |          |

New World Khandallah  
Car Park Extension

Sheet Title

Lighting Calculations  
Point Illuminance  
AS/NZS1158.3.1:2020  
(Sheet 2 of 2)

| Project      | 24-025 | Sheet   | ELO3 |
|--------------|--------|---------|------|
| Scale A3     | 1:250  |         |      |
| AGI File Ref |        | Version | 3    |



PLAN - Area 1  
Scale= 1: 250

| Isoline Legend    |       |
|-------------------|-------|
| Illuminance (Lux) |       |
| Color             | Value |
| Blue              | 0.75  |
| Cyan              | 1.5   |
| Magenta           | 3.5   |
| Red               | 7     |
| Orange            | 10    |

| Rev | Revision Detail         | Date     |
|-----|-------------------------|----------|
| 1   | Issued For LA Review    | 03.04.24 |
| 2   | Issued For Consent      | 08.04.24 |
| 3   | Revised for Proposed DP | 17.04.24 |
| 4   |                         |          |
| 5   |                         |          |
| 6   |                         |          |



|           | Name      | Date     |
|-----------|-----------|----------|
| Surveyed  | N/A       | N/A      |
| Designed  | EWEN CAPE | 03.04.24 |
| Checked   | EWEN CAPE | 17.04.24 |
| Job Title |           |          |

New World Khandallah  
Car Park Extension

Sheet Title

Lighting Calculations  
Iso Illuminance Plot

(Sheet 1 of 2)

|              |        |         |      |
|--------------|--------|---------|------|
| Project      | 24-025 | Sheet   | EL04 |
| Scale A3     | 1:250  | Version | 3    |
| AGI File Ref |        |         |      |

| CALCULATION RESULTS - AS/NZS1158.3.1-2020 SubCategory PC2 |   |             |       |          |           |           |               |
|---|---|-------------|-------|----------|-----------|-----------|---------------|
| Project: 1-General Lighting                               |   |             |       |          |           |           |               |
| Label   | Description                                   | CalcType    | Units | Avg (Eh) | Max (Eph) | Min (Eph) | Max/Avg (Ue2) |
| Eh01  | Carpark Area 1 - Horizontal Illuminance @ FGL | Illuminance | Lux   | 15.74    | 59.7      | 2.1       | 3.79          |
| Eh02  | Carpark Area 2 - Horizontal Illuminance @ FGL | Illuminance | Lux   | 13.78    | 33.9      | 3.5       | 2.46          |
| Eh03  | Carpark Area 3 - Horizontal Illuminance @ FGL | Illuminance | Lux   | 13.91    | 64.7      | 1.3       | 4.65          |

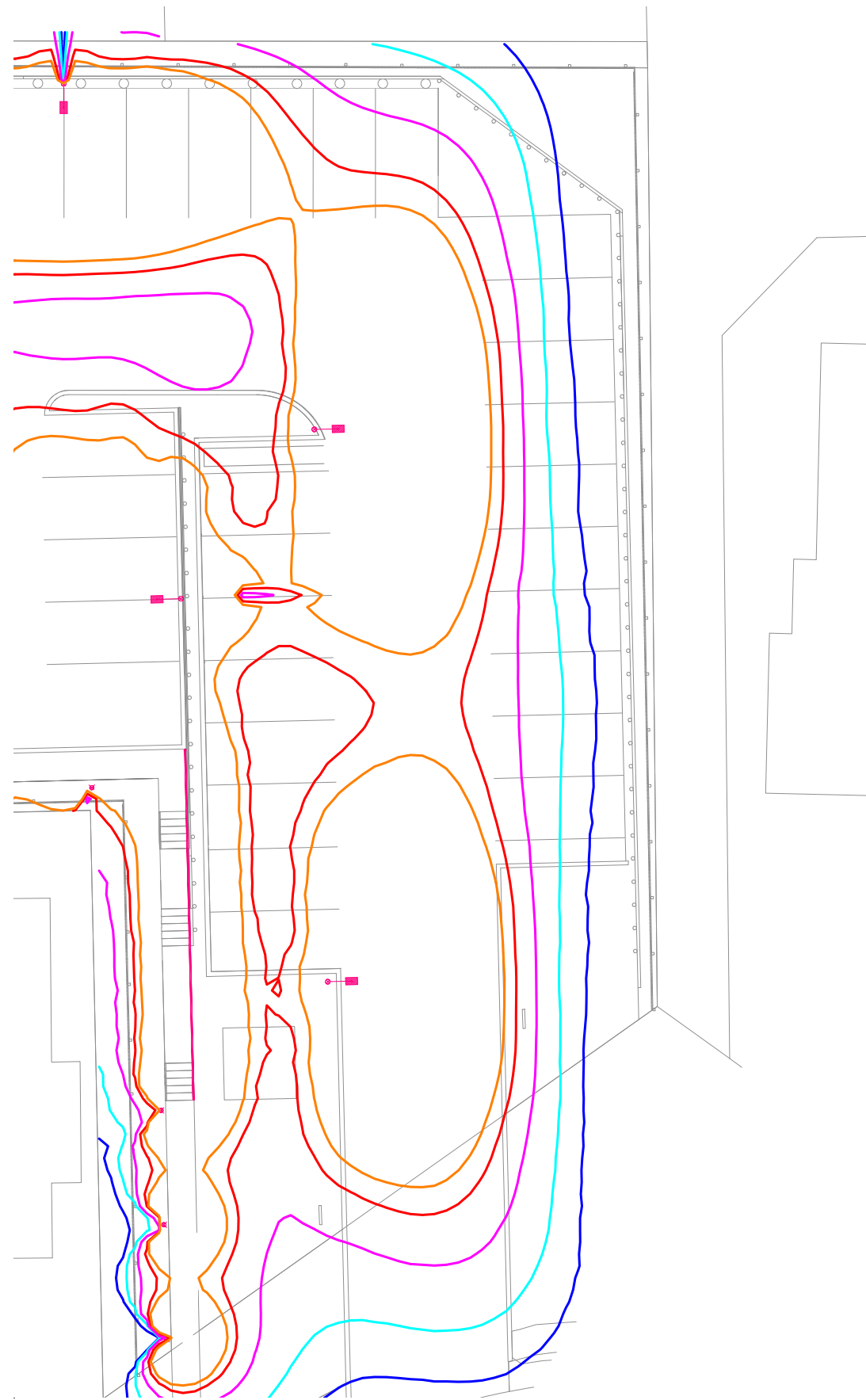

PLAN - Area 2  
Scale= 1: 250

| Isoiline Legend   |       |
|-------------------|-------|
| Illuminance (Lux) |       |
| Color             | Value |
| Blue              | 0.75  |
| Cyan              | 1.5   |
| Magenta           | 3.5   |
| Red               | 7     |
| Orange            | 10    |

| Rev | Revision Detail         | Date     |
|-----|-------------------------|----------|
| 1   | Issued For LA Review    | 03.04.24 |
| 2   | Issued For Consent      | 08.04.24 |
| 3   | Revised for Proposed DP | 17.04.24 |
| 4   |                         |          |
| 5   |                         |          |
| 6   |                         |          |



|           | Name      | Date     |
|-----------|-----------|----------|
| Surveyed  | N/A       | N/A      |
| Designed  | EWEN CAPE | 03.04.24 |
| Checked   | EWEN CAPE | 17.04.24 |
| Job Title |           |          |

New World Khandallah  
Car Park Extension

Sheet Title

Lighting Calculations  
Iso Illuminance Plot

(Sheet 2 of 2)

| Project       | 24-025 | Sheet   | EL05 |
|---------------|--------|---------|------|
| Scale A3      | 1:250  |         |      |
| AGI File Path |        | Version | 3    |

| CALCULATION RESULTS - AS/NZS1158.3.1-2020 SubCategory PC2 |   |             |       |          |           |           |               |
|---|---|-------------|-------|----------|-----------|-----------|---------------|
| Project: 1-General Lighting                               |   |             |       |          |           |           |               |
| Label   | Description                                   | CalcType    | Units | Avg (Eh) | Max (Eph) | Min (Eph) | Max/Avg (Ue2) |
| Eh01  | Carpark Area 1 - Horizontal Illuminance @ FGL | Illuminance | Lux   | 15.74    | 59.7      | 2.1       | 3.79          |
| Eh02  | Carpark Area 2 - Horizontal Illuminance @ FGL | Illuminance | Lux   | 13.78    | 33.9      | 3.5       | 2.46          |
| Eh03  | Carpark Area 3 - Horizontal Illuminance @ FGL | Illuminance | Lux   | 13.91    | 64.7      | 1.3       | 4.65          |

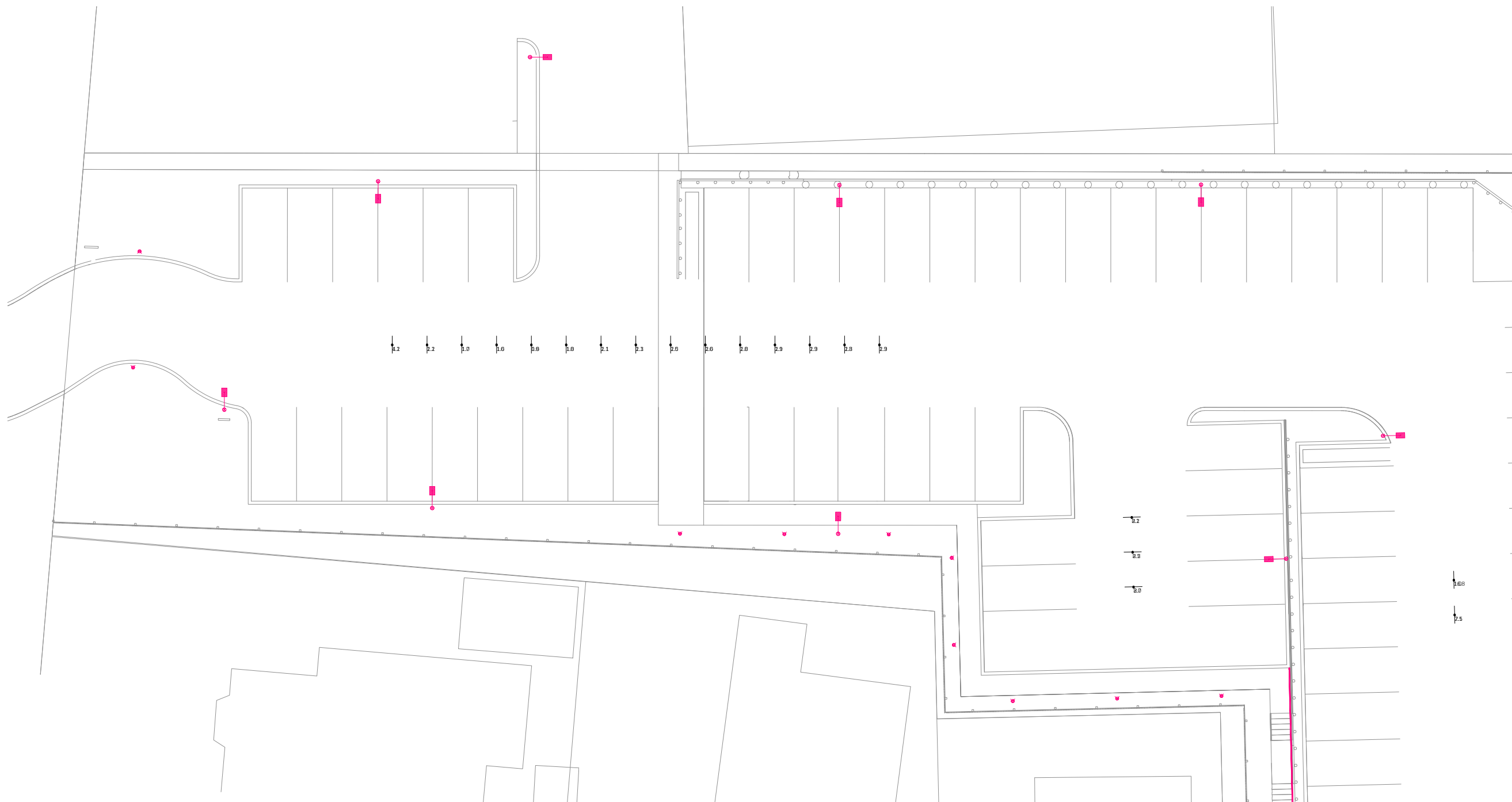

PLAN - Area 1  
Scale= 1: 250

| Rev | Revision Detail         | Date     |
|-----|-------------------------|----------|
| 1   | Issued For LA Review    | 03.04.24 |
| 2   | Issued For Consent      | 08.04.24 |
| 3   | Revised for Proposed DP | 17.04.24 |
| 4   |                         |          |
| 5   |                         |          |
| 6   |                         |          |



|          | Name      | Date     |
|----------|-----------|----------|
| Surveyed | N/A       | N/A      |
| Designed | EWEN CAFE | 03.04.24 |
| Checked  | EWEN CAFE | 17.04.24 |

New World Khandallah  
Car Park Extension

| CALCULATION RESULTS - AS/NZS1158.3.1-2020 SubCategory PC2 |   |             |       |          |           |           |               |
|---|---|-------------|-------|----------|-----------|-----------|---------------|
| Project: 1-General Lighting                               |   |             |       |          |           |           |               |
| Label   | Description                                   | CalcType    | Units | Avg (Eh) | Max (Eph) | Min (Eph) | Max/Avg (Ue2) |
| Eh01  | Carpark Area 1 - Horizontal Illuminance @ FGL | Illuminance | Lux   | 15.74    | 59.7      | 2.1       | 3.79          |
| Eh02  | Carpark Area 2 - Horizontal Illuminance @ FGL | Illuminance | Lux   | 13.78    | 33.9      | 3.5       | 2.46          |
| Eh03  | Carpark Area 3 - Horizontal Illuminance @ FGL | Illuminance | Lux   | 13.91    | 64.7      | 1.3       | 4.65          |

Lighting Calculations  
Vertical Illuminance  
AS/NZS1158.3.1:2020  
(Sheet 1 of 2)

| Project      | 24-025  | Sheet |
|--------------|---------|-------|
| Scale A3     | 1:250   | EL06  |
| AGI File Ref | Version | 3     |

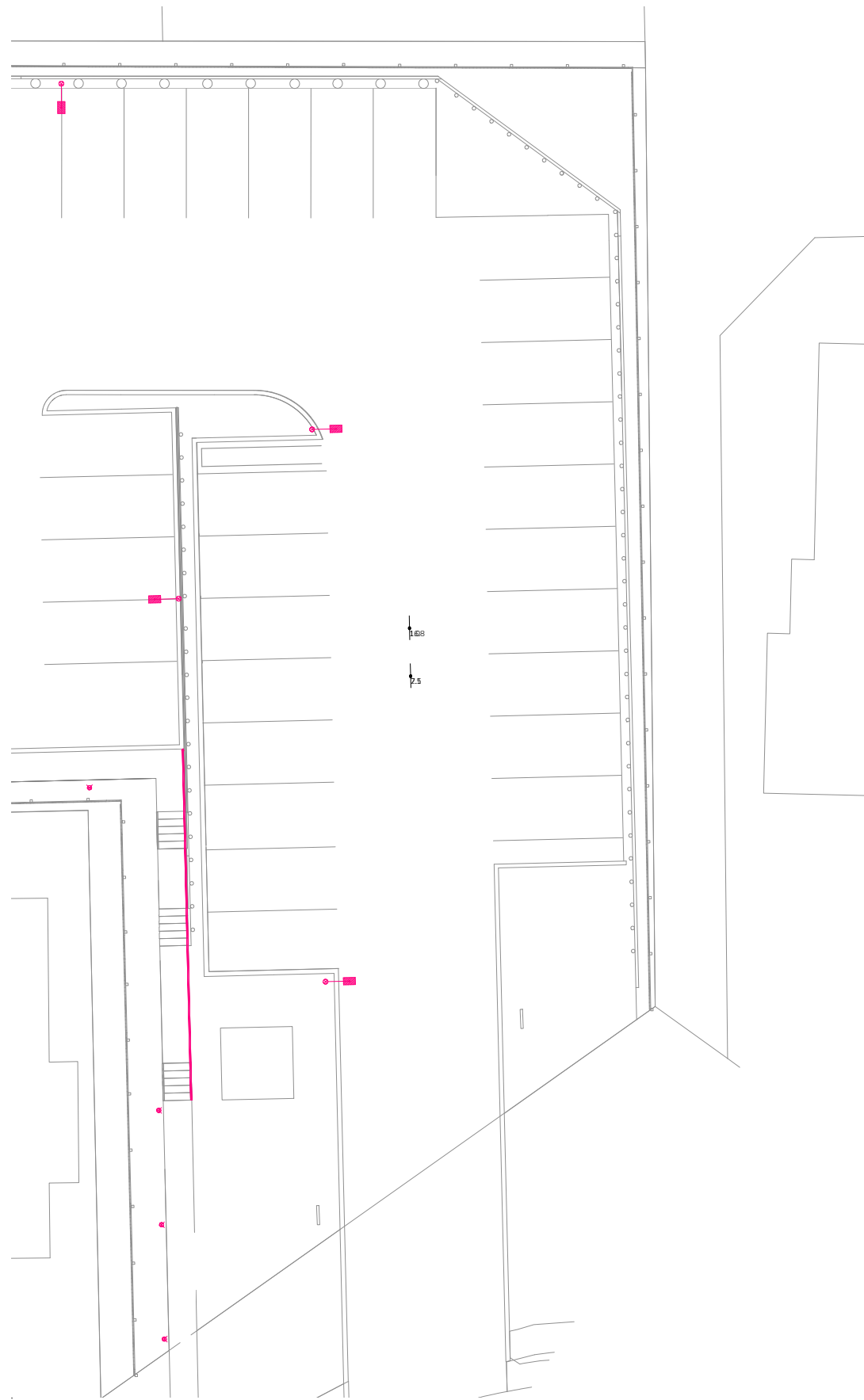

PLAN - Area 2  
Scale= 1: 250

| CALCULATION RESULTS - AS/NZS1158.3.1-2020 SubCategory PC2 |   |             |       |          |           |           |               |
|---|---|-------------|-------|----------|-----------|-----------|---------------|
| Project: 1-General Lighting                               |   |             |       |          |           |           |               |
| Label   | Description                                   | CalcType    | Units | Avg (Eh) | Max (Eph) | Min (Eph) | Max/Avg (Je2) |
| Eh01  | Carpark Area 1 - Horizontal Illuminance @ FGL | Illuminance | Lux   | 15.74    | 59.7      | 2.1       | 3.79          |
| Eh02  | Carpark Area 2 - Horizontal Illuminance @ FGL | Illuminance | Lux   | 13.78    | 33.9      | 3.5       | 2.46          |
| Eh03  | Carpark Area 3 - Horizontal Illuminance @ FGL | Illuminance | Lux   | 13.91    | 64.7      | 1.3       | 4.65          |

| Rev | Revision Detail         | Date     |
|-----|-------------------------|----------|
| 1   | Issued For LA Review    | 03.04.24 |
| 2   | Issued For Consent      | 08.04.24 |
| 3   | Revised for Proposed DP | 17.04.24 |
| 4   |                         |          |
| 5   |                         |          |
| 6   |                         |          |



|           | Name      | Date     |
|-----------|-----------|----------|
| Surveyed  | N/A       | N/A      |
| Designed  | EWEN CAFE | 03.04.24 |
| Checked   | EWEN CAFE | 17.04.24 |
| Job Title |           |          |

New World Khandallah  
Car Park Extension

Sheet Title

Lighting Calculations  
Vertical Illuminance  
AS/NZS1158.3.1:2020  
(Sheet 2 of 2)

| Project      | 24-025 | Sheet   |
|--------------|--------|---------|
| Scale A3     | 1:250  | EL07    |
| AGI File Ref |        | Version |
|              |        | 3       |



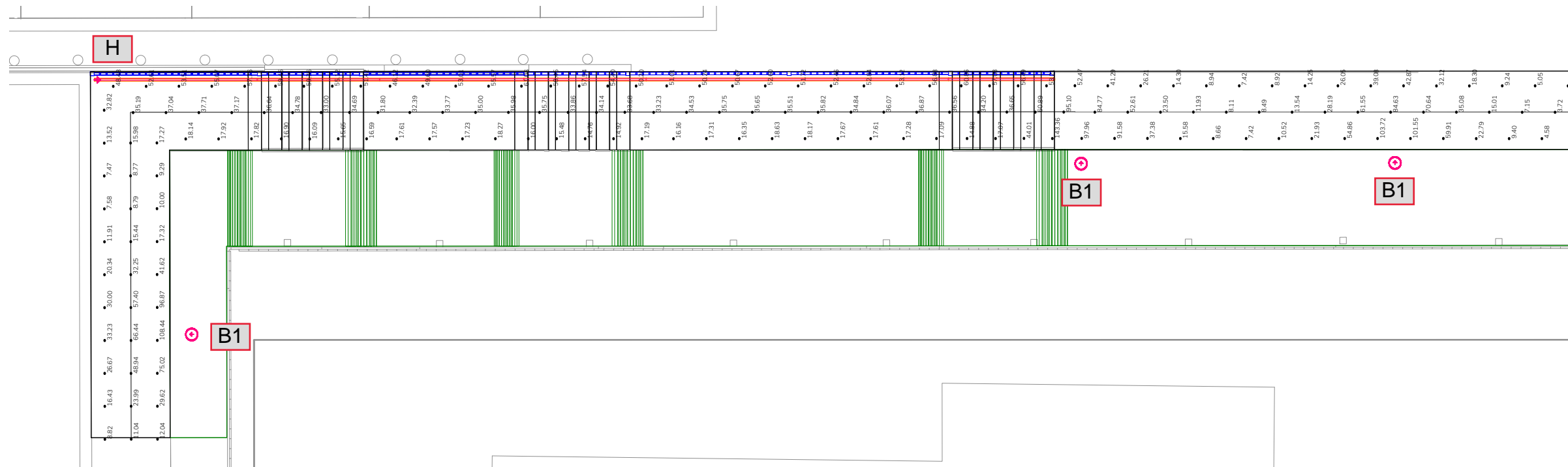
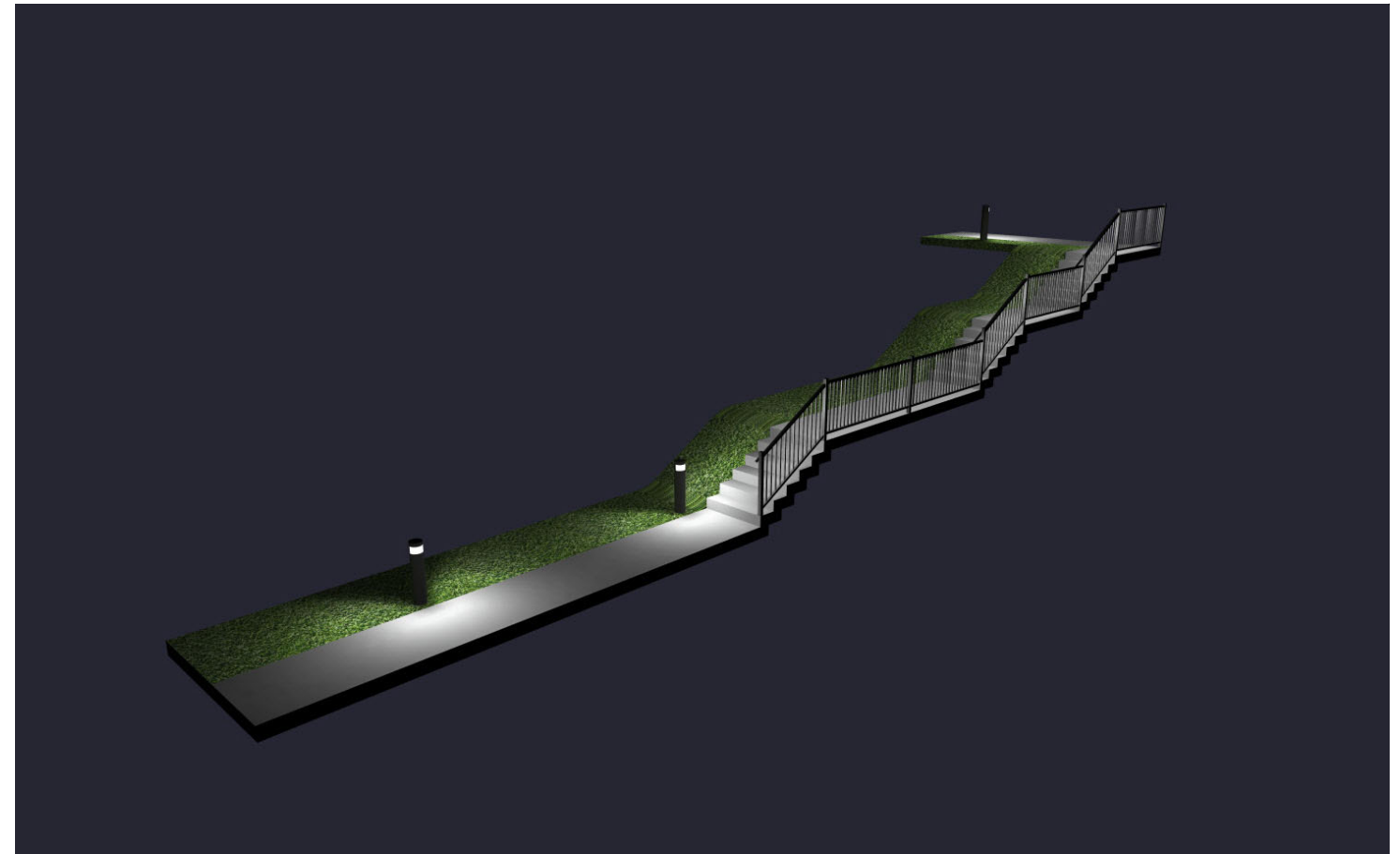
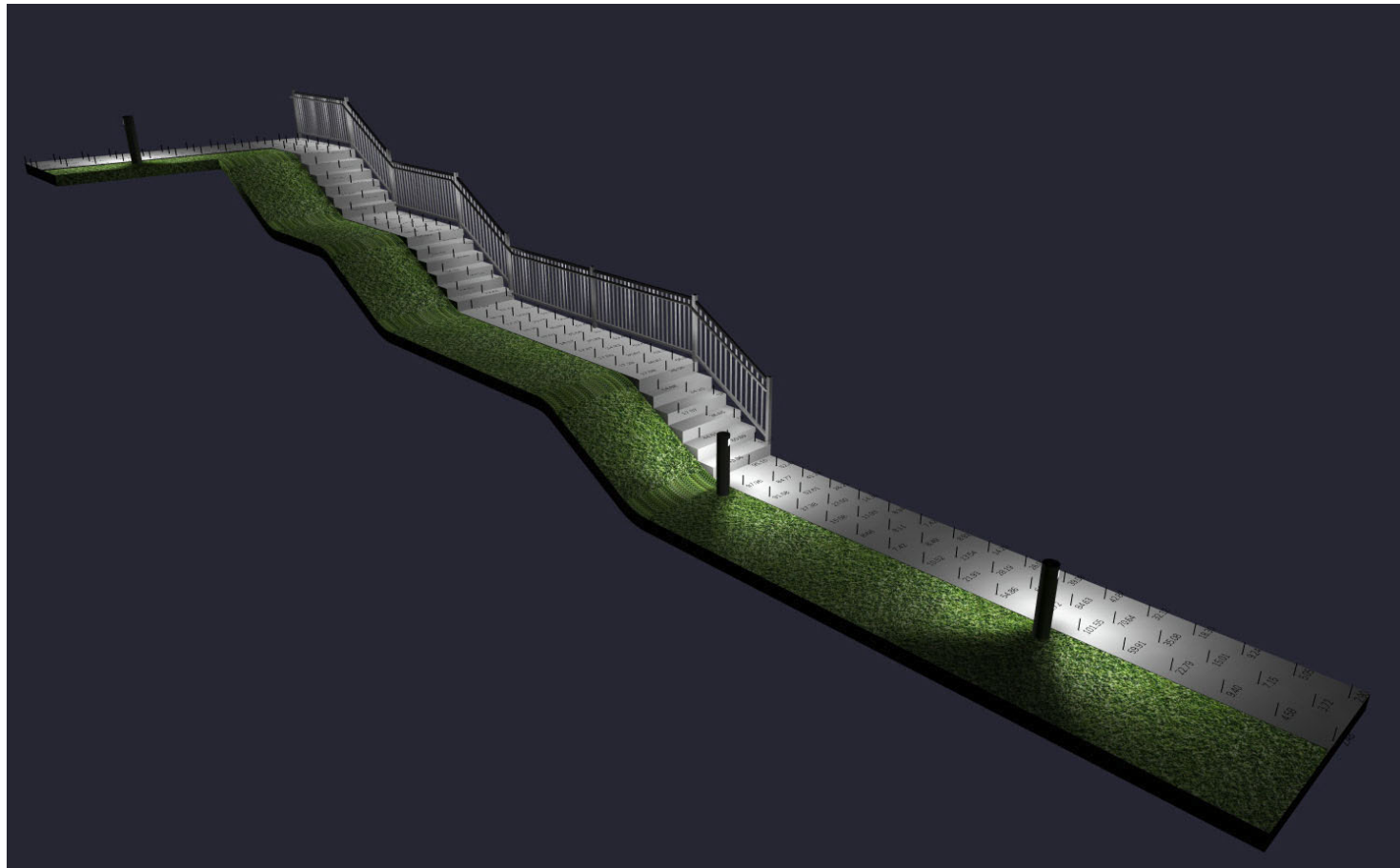

PLAN - Partial Footpath + Steps  
Scale= 1: 75

| CALCULATION RESULTS - AS/NZS1158.3.1-2020 SubCategory PC2 |   |             |       |          |           |           |               |
|---|---|-------------|-------|----------|-----------|-----------|---------------|
| Project: 1-General Lighting                               |   |             |       |          |           |           |               |
| Label   | Description                               | CalcType    | Units | Avg (Eh) | Max (Eph) | Min (Eph) | Max/Avg (Ue2) |
| Eh_Path   | Footpath + Steps - Horizontal Illuminance | Illuminance | Lux   | 35.03    | 143.36    | 2.48      | 4.09          |

| LUMINAIRE SCHEDULE          |     |       |  |                 |      |  |
|-----------------------------|-----|-------|--|-----------------|------|--|
| Project: 1-General Lighting |     |       |  |                 |      |  |
| Symbol                      | Qty | Label | Description  | Luminaire Watts | UWLR |  |
| ⊕                           | 3   | B1    | Disano FARO #510652-39 LED Bollard<br>230v 15w 3000K, 180deg Beam<br>c/w 875mm Round Post, Black Finish  | 15              | 0.15 |  |
| →                           | 1   | H     | SUN Illuminated Handrail System<br>24v 15w/m 3000K - LED Integrated into handrail<br>Length TBC on site. | 9.24            | 0.00 |  |

| Rev | Revision Detail         | Date     |
|-----|-------------------------|----------|
| 1   | Issued For LA Review    | 03.04.24 |
| 2   | Revised For Proposed DP | 17.04.24 |
| 3   |                         |          |
| 4   |                         |          |
| 5   |                         |          |
| 6   |                         |          |



| Name      | Date      |
|-----------|-----------|
| Surveyed  | N/A       |
| Designed  | EWEN CAFE |
| Checked   | EWEN CAFE |
| Job Title |           |

New World Khandallah  
Car Park Extension

Lighting Calculations  
Pedestrian Footpath  
Stairs & Handrail

| Project      | Sheet     |
|--------------|-----------|
| 24-025       | EL08      |
| Scale A3     | 1:250     |
| AGI File Ref | Version 2 |

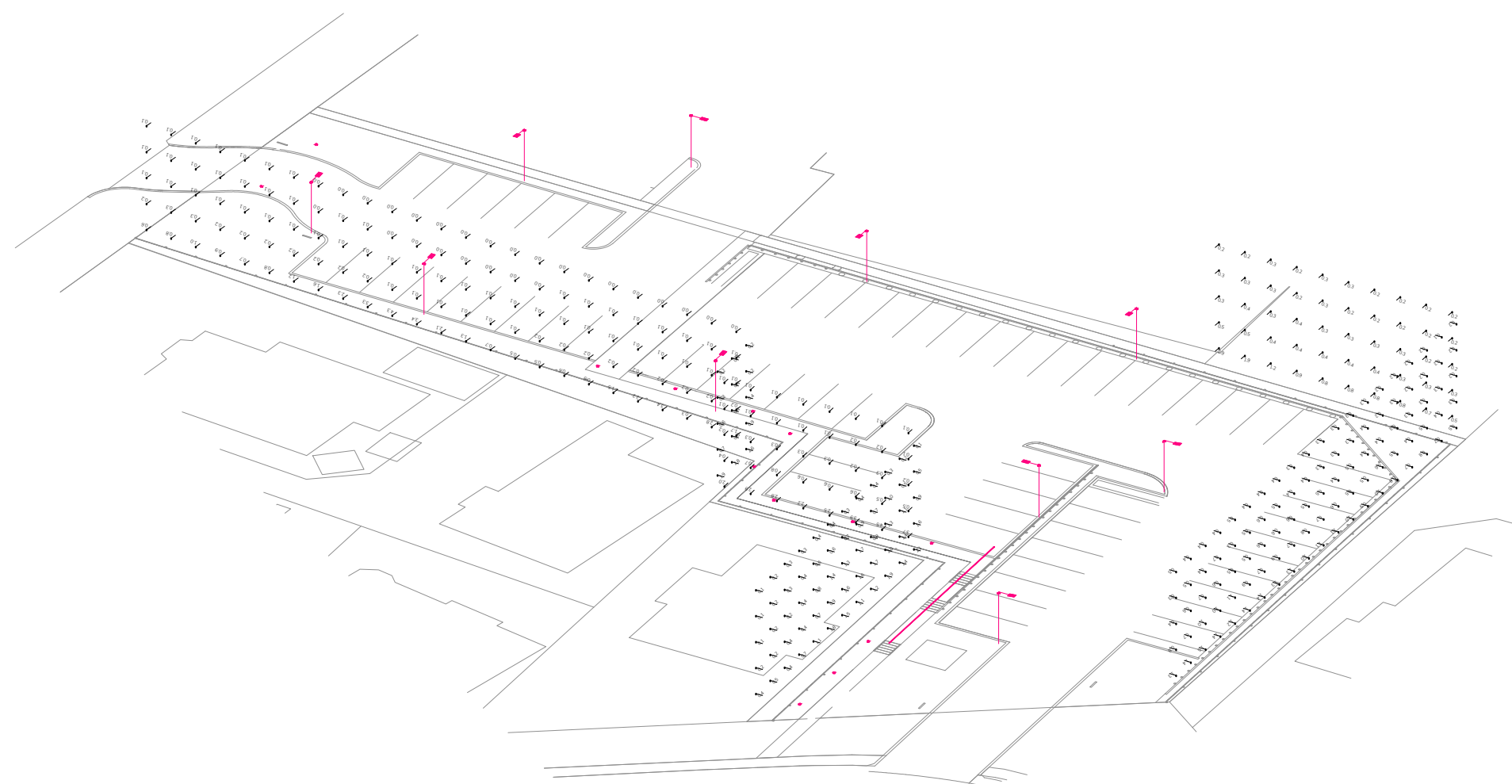

Isometric View - Boundary Calculation Planes

### Obtrusive Light - Compliance Report

Wellington City Council Proposed District Plan  
Outer Residential Zone

Filename: 24-025-NW-Khandhalla-Carpark\_2\_240416  
17/04/2024 8:25:09 am

**Standard LIGHT S2 "Light Spill" (7.00am to 10.00pm)**  
Maximum Allowable Value: 10 Lux

Calculations Tested (6):

| Calculation Label | Test Results | Max. Illum. |
|-------------------|--------------|-------------|
| B1_Ill_Seg1       | PASS         | 2.9         |
| B1_Ill_Seg2       | PASS         | 1.5         |
| B2_Ill_Seg1       | PASS         | 2.1         |
| B2_Ill_Seg2       | PASS         | 4.5         |
| B2_Ill_Seg3       | PASS         | 2.8         |
| B2_Ill_Seg4       | PASS         | 4.3         |

**Standard LIGHT S3 "Glare" (7.00am to 10.00pm)**  
Maximum Allowable Value: 12500 Cd

Calculations Tested (6):

| Calculation Label | Test Results |
|-------------------|--------------|
| B1_Cd_Seg1        | PASS         |
| B1_Cd_Seg2        | PASS         |
| B2_Cd_Seg1        | PASS         |
| B2_Cd_Seg2        | PASS         |
| B2_Cd_Seg3        | PASS         |
| B2_Cd_Seg4        | PASS         |

| Rev | Revision Detail         | Date     |
|-----|-------------------------|----------|
| 1   | Issued For LA Review    | 03.04.24 |
| 2   | Issued For Consent      | 08.04.24 |
| 3   | Revised for Proposed DP | 17.04.24 |
| 4   |                         |          |
| 5   |                         |          |
| 6   |                         |          |



|          | Name      | Date     |
|----------|-----------|----------|
| Surveyed | N/A       | N/A      |
| Designed | EWEN CAFE | 03.04.24 |
| Checked  | EWEN CAFE | 17.04.24 |

Job Title  
**New World Khandallah  
Car Park Extension**

Sheet Title

**Lighting Calculations  
Lightspill & Glare  
Boundary Assessment**

| Project      | 24-025 | Sheet   | EL09 |
|--------------|--------|---------|------|
| Scale A3     | NTS    |         |      |
| AGI File Ref |        | Version | 3    |

| Calculation Summary            |   |                 |         |       |     |
|--------------------------------|---|-----------------|---------|-------|-----|
| Project: 2-Spill Light & Glare |   |                 |         |       |     |
| Label                          | Description                                     | CalcType        | Units   | Avg   | Max |
| B1_Cd_Seg1                     | Boundary Assessment South + Southeast Fenceline | Obtrusive - Cd  | Candela | 78.42 | 252 |
| B1_Cd_Seg2                     | Boundary Assessment South + Southeast Fenceline | Obtrusive - Cd  | Candela | 76.39 | 112 |
| B1_Ill_Seg1                    | Boundary Assessment South + Southeast Fenceline | Obtrusive - Ill | Lux     | 0.46  | 2.9 |
| B1_Ill_Seg2                    | Boundary Assessment South + Southeast Fenceline | Obtrusive - Ill | Lux     | 0.58  | 1.5 |
| B2_Cd_Seg1                     | Boundary Assessment - Western Fencelines        | Obtrusive - Cd  | Candela | 57.13 | 95  |
| B2_Cd_Seg2                     | Boundary Assessment - Western Fencelines        | Obtrusive - Cd  | Candela | 77.53 | 503 |
| B2_Cd_Seg3                     | Boundary Assessment - Western Fencelines        | Obtrusive - Cd  | Candela | 21.87 | 61  |
| B2_Cd_Seg4                     | Boundary Assessment - Western Fencelines        | Obtrusive - Cd  | Candela | 54.31 | 126 |
| B2_Ill_Seg1                    | Boundary Assessment - Western Fencelines        | Obtrusive - Ill | Lux     | 0.78  | 2.1 |
| B2_Ill_Seg2                    | Boundary Assessment - Western Fencelines        | Obtrusive - Ill | Lux     | 0.83  | 4.5 |
| B2_Ill_Seg3                    | Boundary Assessment - Western Fencelines        | Obtrusive - Ill | Lux     | 0.85  | 2.8 |
| B2_Ill_Seg4                    | Boundary Assessment - Western Fencelines        | Obtrusive - Ill | Lux     | 0.39  | 4.3 |