

L700 REV.

3D VIEWS KEY PLAN

FOODSTUFFS NORTH ISLAND
 F537 NEW WORLD KHANDALLAH
 26 GANGES ROAD

RESOURCE CONSENT

Contractors shall verify all dimensions on site before commencing work. Do not scale from the drawings. If in doubt ask. Copyright of this drawing is vested in Designgroup Stapleton Elliott.

PROJECT No. **F537**

PLOT DATE. **25/09/2023 2:05:44 pm**

NO.	DESCRIPTION	DATE
-----	-------------	------

Wellington	+64 4 920 0032	wm@dgse.co.nz
Palmerston North	+64 6 357 4534	pn@dgse.co.nz
Tauranga	+64 7 925 6238	tr@dgse.co.nz
Napier	+64 6 835 6173	np@dgse.co.nz
Auckland	+64 9 976 8288	ak@dgse.co.nz



designgroup
stapleton elliott



3D VIEWS KEY PLAN
 SCALE @ A3 - 1 : 500 | SCALE @ A1 - DOUBLE SCALE

- - - Retaining Wall
- Acoustic Wall
- Approx. viewshaft

3D VIEWS

FOODSTUFFS NORTH ISLAND
 F537 NEW WORLD KHANDALLAH
 26 GANGES ROAD

RESOURCE CONSENT

Contractors shall verify all dimensions on site before commencing work. Do not scale from the drawings. If in doubt ask. Copyright of this drawing is vested in Designgroup Stapleton Elliott.

PROJECT No. **F537**

PLOT DATE. **25/09/2023 2:06:21 pm**

NO.	DESCRIPTION	DATE
-----	-------------	------

Wellington	+64 4 920 0032	wn@dgse.co.nz
Palmerston North	+64 6 357 4534	pn@dgse.co.nz
Tauranga	+64 7 925 6238	tr@dgse.co.nz
Napier	+64 6 835 6173	np@dgse.co.nz
Auckland	+64 9 976 8288	ak@dgse.co.nz

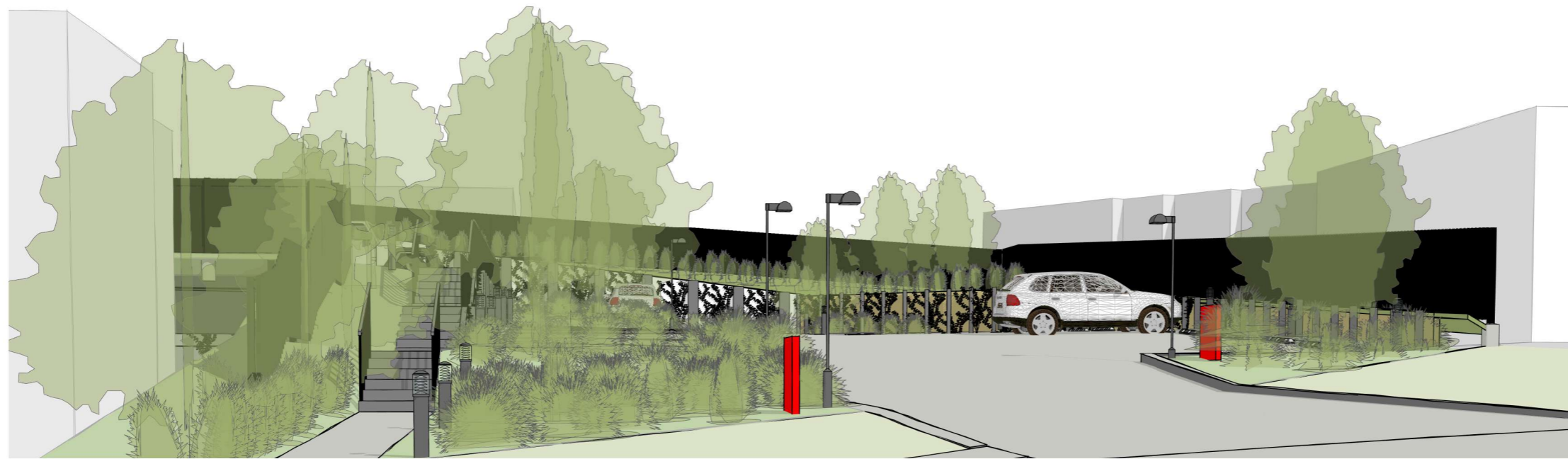

NICHOLSON RD ENTRANCE
 SCALE @ A3 - | SCALE @ A1 - DOUBLE SCALE



DEKKA ST ENTRANCE
 SCALE @ A3 - | SCALE @ A1 - DOUBLE SCALE



3D VIEWS

FOODSTUFFS NORTH ISLAND
 F537 NEW WORLD KHANDALLAH
 26 GANGES ROAD

RESOURCE CONSENT

Contractors shall verify all dimensions on site before commencing work. Do not scale from the drawings. If in doubt ask. Copyright of this drawing is vested in Designgroup Stapleton Elliott.

PROJECT No. **F537**
 PLOT DATE. **25/09/2023 2:06:48 pm**



PEDESTRIAN LINK
 SCALE @ A3 - | SCALE @ A1 - DOUBLE SCALE

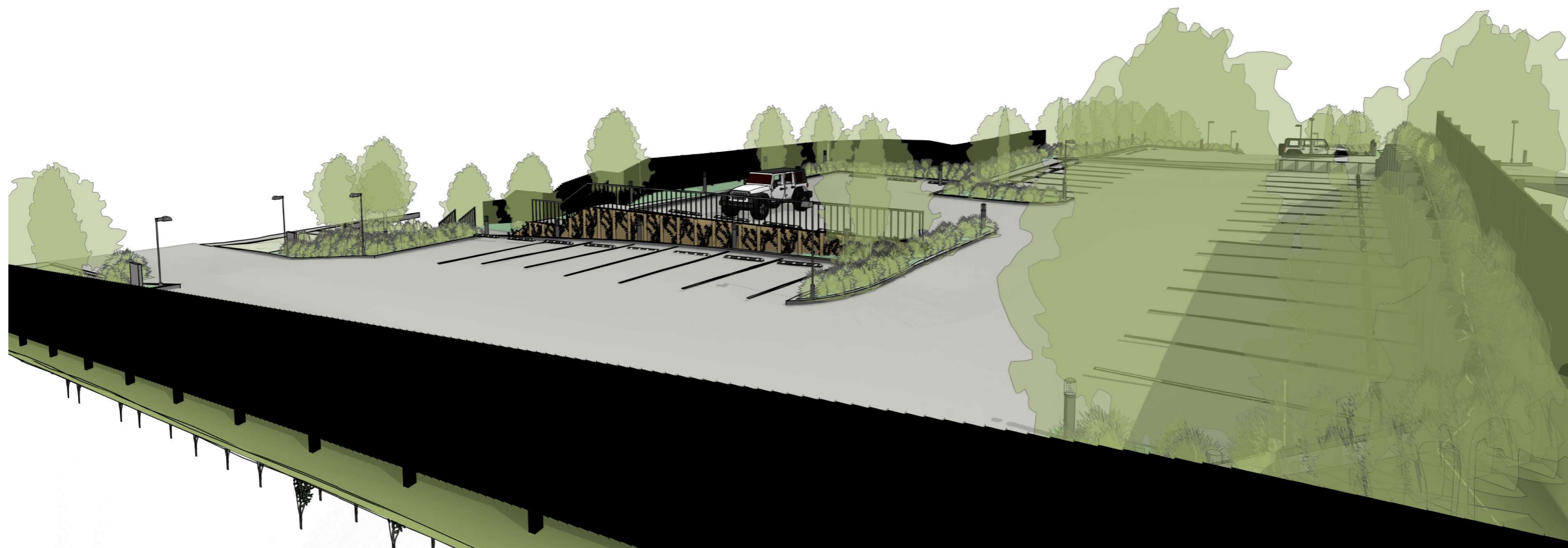

ADJOINING PROPERTY
 SCALE @ A3 - | SCALE @ A1 - DOUBLE SCALE

NO.	DESCRIPTION	DATE
-----	-------------	------

Wellington	+64 4 920 0032	wm@dgse.co.nz
Palmerston North	+64 6 357 4534	pn@dgse.co.nz
Tauranga	+64 7 925 6238	tr@dgse.co.nz
Napier	+64 6 835 6173	np@dgse.co.nz
Auckland	+64 9 976 8288	ak@dgse.co.nz